

RL-2515

SURFACE MOUNT CHIP INDUCTORS

DESCRIPTION

- Chip Inductors

ENVIRONMENTAL DATA

- Storage temperature range: -40°C to +125°C
- Operating temperature range: -40°C to +130°C

PACKAGING INFORMATION

- Packaging information: pg. 489, 494

FEATURES & APPLICATIONS

- Offers over a hundred standard values of miniature inductors that are designed specifically for compact assemblies requiring surface mount components
- Available on reels for automated assemblies or in bulk packaging
- Standard 1210 package

Verify operation with sample in actual circuit. Order samples at www.rencousa.com.

MECHANICAL DIMENSIONS

U.S. Standard (mm)

PART NUMBER	A (MAX.)	B (MAX.)	C (REF.)	D (MIN.)	E (MAX.)	F ±0.004 (0.1)
RL-2515	0.138 (3.50)	0.087 (2.40)	0.24 (0.60)	0.008 (0.20)	0.106 (2.70)	0.075 (1.90)

PART NUMBER	PART WEIGHT
RL-2515	0.12g (0.004oz)

G (REF.)	H (REF.)	I (REF.)
0.079 (2.00)	0.047 (1.20)	0.079 (2.00)

FRONT VIEW

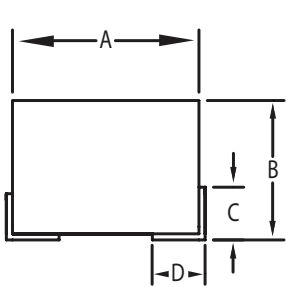

SIDE VIEW

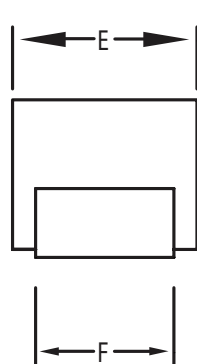

RECOMMENDED LAND PATTERN

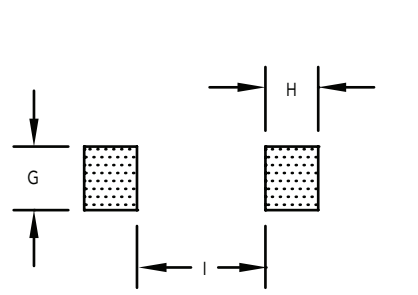

SCHEMATIC

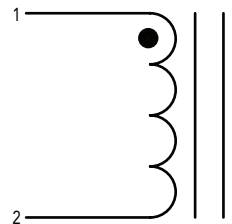

RL-2515

Renco Part No. RL-2515	Inductance (μ H)	DCR Max. (Ohms)	SRF (MHz) Min.	Q Typical Min.	I _{rms} (mA)	Measuring Frequency (MHz)
RL-2515-0.15	0.15 \pm 20%	0.16	290.0	30.0	610.0	25.200
RL-2515-0.18	0.18 \pm 20%	0.18	260.0	30.0	580.0	25.200
RL-2515-0.22	0.22 \pm 20%	0.20	230.0	30.0	550.0	25.200
RL-2515-0.27	0.27 \pm 20%	0.22	210.0	30.0	520.0	25.200
RL-2515-0.33	0.33 \pm 20%	0.24	190.0	30.0	500.0	25.200
RL-2515-0.39	0.38 \pm 20%	0.26	170.0	30.0	480.0	25.200
RL-2515-0.47	0.47 \pm 20%	0.29	150.0	30.0	460.0	25.200
RL-2515-0.56	0.56 \pm 20%	0.33	130.0	30.0	430.0	25.200
RL-2515-0.68	0.68 \pm 20%	0.35	120.0	30.0	410.0	25.200
RL-2515-0.82	0.82 \pm 20%	0.39	100.0	30.0	390.0	25.200
RL-2515-1.0	1.00 \pm 20%	0.44	90.0	30.0	370.0	7.960
RL-2515-1.2	1.20 \pm 20%	0.48	85.0	30.0	350.0	7.960
RL-2515-1.5	1.50 \pm 20%	0.54	70.0	30.0	330.0	7.960
RL-2515-1.8	1.80 \pm 20%	0.58	60.0	30.0	320.0	7.960
RL-2515-2.2	2.20 \pm 20%	0.67	50.0	30.0	300.0	7.960
RL-2515-2.7	2.70 \pm 20%	0.72	45.0	30.0	290.0	7.960
RL-2515-3.3	3.30 \pm 10%	0.80	40.0	30.0	270.0	7.960
RL-2515-3.9	3.90 \pm 10%	0.88	37.0	30.0	260.0	7.960
RL-2515-4.7	4.70 \pm 10%	0.95	32.0	30.0	250.0	7.960
RL-2515-5.6	5.60 \pm 10%	1.10	30.0	30.0	230.0	7.960
RL-2515-6.8	6.80 \pm 10%	1.20	28.0	30.0	220.0	7.960
RL-2515-8.2	8.20 \pm 10%	1.30	25.0	30.0	215.0	7.960
RL-2515-10	10.00 \pm 10%	1.40	23.0	30.0	200.0	2.520
RL-2515-12	12.00 \pm 10%	1.60	20.0	30.0	190.0	2.520
RL-2515-15	15.00 \pm 10%	1.80	19.0	30.0	180.0	2.520
RL-2515-18	18.00 \pm 10%	1.90	17.0	30.0	175.0	2.520
RL-2515-22	22.00 \pm 10%	3.10	18.0	30.0	140.0	2.520
RL-2515-27	27.00 \pm 10%	3.50	14.0	30.0	130.0	2.520
RL-2515-33	33.00 \pm 10%	3.90	13.0	30.0	125.0	2.520
RL-2515-39	39.00 \pm 10%	4.30	12.0	30.0	120.0	2.520
RL-2515-47	47.00 \pm 10%	6.00	10.0	30.0	100.0	2.520
RL-2515-56	56.00 \pm 10%	6.50	9.0	30.0	95.0	2.520
RL-2515-68	68.00 \pm 10%	7.30	9.0	30.0	90.0	2.520
RL-2515-82	82.00 \pm 10%	10.20	8.0	30.0	75.0	2.520
RL-2515-100	100.00 \pm 10%	11.30	7.0	20.0	70.0	0.796

NOTES:

1. ELECTRICAL SPECIFICATIONS MEASURED AT 25°C
2. I_{rms} - CURRENT THAT CAUSES THE TEMPERATURE TO RISE APPROX. 20°C ABOVE AMBIENT OF 25°C

**ORDERING INFORMATION:
PART NUMBER SYSTEM**

RL-2505-XXX-XX

"T" OR "B" FOR TAPE
OR BULK PACKAGING

ORDER QUANTITY: 2,000 PIECES FOR TAPE AND
REEL, ANY QUANTITY FOR BULK PACKAGING

INDUCTANCE VALUE



RENCO ELECTRONICS INC.

595 International Place, Rockledge, FL 32955-4200 USA • www.rencousa.com • ISO 9001 Certified
Toll Free Engineering Hot Line: 800.645.5828 • P: 321.637.1000 • F: 321.637.1600

