

# RL-1608

## SMT POWER INDUCTORS

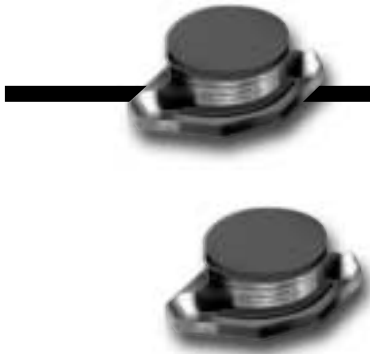

The RL-1608 Series offers surface mount power inductors in our smallest package with a footprint of .26" x .175". With a low cost, high energy storage and low resistance they are ideal for communication, computer and converter applications. Specifically designed with a flat top for reliable pick and place operations. They can withstand solder flow, reflow and wave soldering applications. Available in 19 values with inductance ratings from 1.0 $\mu$ H to 1.0mH and currents up to 2.9 Amps.

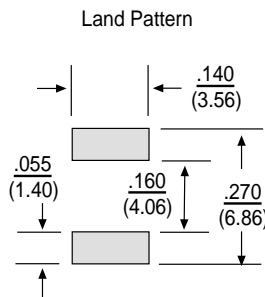
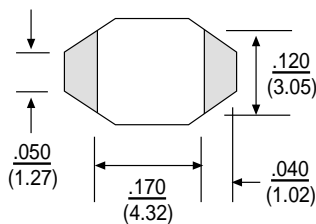
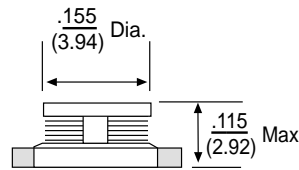
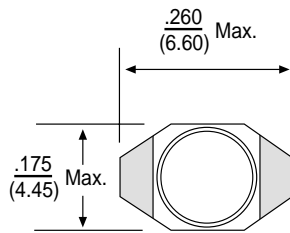

PART NUMBER	Inductance <sup>1</sup> ( $\mu$ H $\pm$ 20%)	DCR max. (Ohms)	DC SAT <sup>2</sup> (Amps)	Rated Current <sup>3</sup> (Amps)
RL-1608-1.0	1.0	.05	2.90	2.9
RL-1608-1.5	1.5	.05	2.60	2.8
RL-1608-2.2	2.2	.07	2.30	2.4
RL-1608-3.3	3.3	.08	2.00	2.0
RL-1608-4.7	4.7	.09	1.50	1.5
RL-1608-6.8	6.8	.13	1.20	1.4
RL-1608-10	10	.16	1.10	1.1
RL-1608-15	15	.23	0.90	1.2
RL-1608-22	22	.37	0.70	0.8
RL-1608-33	33	.51	0.58	0.6
RL-1608-47	47	.64	0.50	0.5
RL-1608-68	68	.86	0.40	0.4
RL-1608-100	100	1.27	0.31	0.3
RL-1608-150	150	2.00	0.27	0.25
RL-1608-220	220	2.65	0.22	0.2
RL-1608-330	330	3.80	0.18	0.16
RL-1608-470	470	5.06	0.16	0.15
RL-1608-680	680	9.20	0.14	0.12
RL-1608-1000	1000	13.8	0.10	0.07

Packaged 2,000 parts per reel.

ALL DIMENSIONS IN INCHES (mm)

1. Tested at 100 kHz, 0.1 Vrms.
2. Inductance drop = 10% typ.
3.  $\Delta$ T = 15°C rise typ.

Operating temperature range -40°C to +85°C.



## RENCO ELECTRONICS, INC.

595 International Place, Rockledge, FL 32955-4200 USA

(321) 637-1000 • Toll Free Engineering Hot line 800-645-5828

Fax: (321) 637-1600 Web Site: [www.rencousa.com](http://www.rencousa.com) E-mail: [sales@rencousa.com](mailto:sales@rencousa.com)