

**CAUTION**  
**NOT RECOMMENDED FOR DC**  
**APPLICATIONS**  
**(DC SATURATION CURRENTS VERY LOW)**

# RL-1123

## RL-1124

### SHIELDED INDUCTORS

*FERRITE COILFORM & SHELL*



The RL-1123/RL-1124 Series of low cost, miniature shielded coils come in wide inductance and current ranges. Their small size make them extremely useful in compact audio filters, tone control circuits, and amplifiers and wherever high inductance coils are needed. These Shielded Inductors make an excellent low cost alternative to fixed pot cores. Inductances range from 1 $\mu$  to 47H and currents are rated from .0054 to 1.5 Amps.

## Other Applications:

- Low Level Power Supplies
- Filters
- Switching Circuits
- Telecommunications

**Specifications:** Supplied with PVC outer wrap.

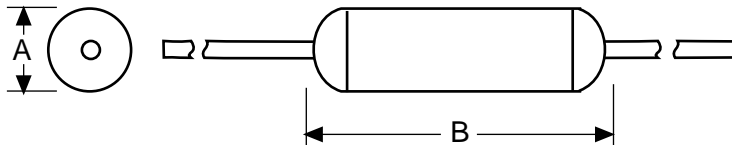

| MAXIMUM DIMENSIONS: |         |         |
|---------------------|---------|---------|
|                     | RL-1123 | RL-1124 |
| A                   | .550    | .300    |
| B                   | 1.000   | .725    |

ALL DIMENSIONS IN INCHES

- Weight: RL-1123 15 grams maximum approx.  
 RL-1124 5 grams maximum approx.
- Leads No. 20 AWG tinned copper 1" long min.

ORDERING INFORMATION;  
 Note: Indicate tolerance after part numer.  
 Ex. RL-1123-1000 20%



## RENCO ELECTRONICS, INC.

✉ 595 International Place, Rockledge, FL 32955-4200 USA

☎ (321) 637-1000 • Toll Free Engineering Hot line 800-645-5828

📠 Fax: (321) 637-1600 🌐 Web Site: [www.rencousa.com](http://www.rencousa.com) ✉ E-mail: [sales@rencousa.com](mailto:sales@rencousa.com)

| <b>RL-1123</b> |            |                 |                                 |
|----------------|------------|-----------------|---------------------------------|
| Renco Part No. | Inductance | Max. DCR (Ohms) | Suggested Rated Current AC Amps |
| RL-1123-.0010  | 1.0μH      | .0066           | 1.5                             |
| RL-1123-.0012  | 1.2μH      | .008            | 1.4                             |
| RL-1123-.0015  | 1.5μH      | .008            | 1.4                             |
| RL-1123-.0018  | 1.8μH      | .008            | 1.4                             |
| RL-1123-.0022  | 2.2μH      | .008            | 1.4                             |
| RL-1123-.0027  | 2.7μH      | .009            | 1.4                             |
| RL-1123-.0033  | 3.3μH      | .009            | 1.4                             |
| RL-1123-.0039  | 3.9μH      | .009            | 1.4                             |
| RL-1123-.0047  | 4.7μH      | .012            | 1.4                             |
| RL-1123-.0056  | 5.6μH      | .012            | 1.4                             |
| RL-1123-.0068  | 6.8μH      | .012            | 1.4                             |
| RL-1123-.0082  | 8.2μH      | .013            | 1.4                             |
| RL-1123-.0100  | 10.0μH     | .013            | 1.4                             |
| RL-1123-.0120  | 12.0μH     | .013            | 1.4                             |
| RL-1123-.0150  | 15.0μH     | .014            | 1.4                             |
| RL-1123-.0180  | 18.0μH     | .017            | 1.4                             |
| RL-1123-.0220  | 22.0μH     | .020            | 1.4                             |
| RL-1123-.0270  | 27.0μH     | .020            | 1.4                             |
| RL-1123-.0330  | 33.0μH     | .022            | 1.4                             |
| RL-1123-.0390  | 39.0μH     | .023            | 1.35                            |
| RL-1123-.0470  | 47.0μH     | .024            | 1.35                            |
| RL-1123-.0560  | 56.0μH     | .027            | 1.35                            |
| RL-1123-.0680  | 68.0μH     | .028            | 1.35                            |
| RL-1123-.0820  | 82.0μH     | .029            | 1.35                            |
| RL-1123-.1000  | 100.0μH    | .030            | 1.35                            |
| RL-1123-.1200  | 120.0μH    | .034            | 1.35                            |
| RL-1123-.1500  | 150.0μH    | .036            | 1.35                            |
| RL-1123-.1800  | 180.0μH    | .044            | 1.35                            |
| RL-1123-.2200  | 220.0μH    | .047            | 1.35                            |
| RL-1123-.2700  | 270.0μH    | .049            | 1.35                            |
| RL-1123-.3300  | 330.0μH    | .052            | 1.30                            |
| RL-1123-.3900  | 390.0μH    | .053            | 1.30                            |
| RL-1123-.4700  | 470.0μH    | .058            | 1.30                            |
| RL-1123-.5600  | 560.0μH    | .063            | 1.30                            |
| RL-1123-.6800  | 680.0μH    | .068            | 1.30                            |
| RL-1123-.8200  | 820.0μH    | .080            | 1.30                            |
| RL-1123-1.0    | 1.0mH      | .091            | 1.30                            |
| RL-1123-1.2    | 1.2mH      | .110            | 1.25                            |
| RL-1123-1.5    | 1.5mH      | .116            | 1.25                            |
| RL-1123-1.8    | 1.8mH      | .130            | 1.25                            |
| RL-1123-2.2    | 2.2mH      | .177            | 1.12                            |
| RL-1123-2.7    | 2.7mH      | .190            | 1.12                            |
| RL-1123-3.3    | 3.3mH      | .213            | 1.12                            |
| RL-1123-3.9    | 3.9mH      | .287            | .88                             |
| RL-1123-4.7    | 4.7mH      | .364            | .88                             |
| RL-1123-5.6    | 5.6mH      | .440            | .707                            |
| RL-1123-6.8    | 6.8mH      | .662            | .556                            |
| RL-1123-8.2    | 8.2mH      | .700            | .556                            |
| RL-1123-10     | 10.0mH     | .741            | .556                            |
| RL-1123-12     | 12.0mH     | .827            | .556                            |
| RL-1123-15     | 15.0mH     | 1.10            | .437                            |
| RL-1123-18     | 18.0mH     | 1.25            | .437                            |
| RL-1123-22     | 22.0mH     | 1.67            | .350                            |
| RL-1123-27     | 27.0mH     | 1.92            | .227                            |
| RL-1123-33     | 33.0mH     | 2.76            | .224                            |

| <b>RL-1123</b> |            |                 |                                 |
|----------------|------------|-----------------|---------------------------------|
| Renco Part No. | Inductance | Max. DCR (Ohms) | Suggested Rated Current AC Amps |
| RL-1123-39     | 39.0mH     | 3.48            | .224                            |
| RL-1123-47     | 47.0mH     | 4.32            | .224                            |
| RL-1123-56     | 56.0mH     | 4.44            | .224                            |
| RL-1123-68     | 68.0mH     | 4.80            | .224                            |
| RL-1123-82     | 82.0mH     | 7.20            | .175                            |
| RL-1123-100    | 100.0mH    | 8.50            | .175                            |
| RL-1123-120    | 120.0mH    | 10.56           | .139                            |
| RL-1123-150    | 150.0mH    | 12.24           | .139                            |
| RL-1123-180    | 180.0mH    | 13.68           | .139                            |
| RL-1123-220    | 220.0mH    | 24.00           | .110                            |
| RL-1123-270    | 270.0mH    | 27.00           | .088                            |
| RL-1123-330    | 330.0mH    | 32.00           | .080                            |
| RL-1123-390    | 390.0mH    | 37.08           | .071                            |
| RL-1123-470    | 470.0mH    | 39.48           | .071                            |
| RL-1123-560    | 560.0mH    | 46.68           | .071                            |
| RL-1123-680    | 680.0mH    | 56.80           | .071                            |
| RL-1123-820    | 820.0mH    | 67.30           | .056                            |
| RL-1123-1000   | 1.0H       | 74.64           | .056                            |
| RL-1123-1200   | 1.2H       | 101.0           | .043                            |
| RL-1123-1500   | 1.5H       | 160.0           | .034                            |
| RL-1123-1800   | 1.8H       | 180.0           | .034                            |
| RL-1123-2200   | 2.2H       | 208.0           | .027                            |
| RL-1123-2700   | 2.7H       | 222.0           | .027                            |
| RL-1123-3300   | 3.3H       | 259.0           | .027                            |
| RL-1123-3900   | 3.9H       | 314.0           | .027                            |
| RL-1123-4700   | 4.7H       | 382.0           | .027                            |
| RL-1123-5600   | 5.6H       | 472.0           | .022                            |
| RL-1123-6800   | 6.8H       | 510.0           | .022                            |
| RL-1123-8200   | 8.2H       | 714.0           | .017                            |
| RL-1123-10000  | 10.0H      | 829.0           | .014                            |
| RL-1123-12000  | 12.0H      | 1060.0          | .014                            |
| RL-1123-15000  | 15.0H      | 1200.0          | .014                            |
| RL-1123-18000  | 18.0H      | 1730.0          | .011                            |
| RL-1123-22000  | 22.0H      | 2290.0          | .0086                           |
| RL-1123-27000  | 27.0H      | 2380.0          | .008                            |
| RL-1123-33000  | 33.0H      | 3860.0          | .0069                           |
| RL-1123-39000  | 39.0H      | 4360.0          | .0069                           |
| RL-1123-47000  | 47.0H      | 5170.0          | .0054                           |

Inductance values shown in μH = microHenrys,  
mH = milliHenrys and H = Henrys

**NOTES:**

1. Ends epoxy sealed
2. -55°C to +130°C
3. 20% tolerance standard
4. 10% tolerance optional
5. Available taped and reeled.
6. Inductance measured at 1KHz



**RENCO ELECTRONICS, INC.**

✉ 595 International Place, Rockledge, FL 32955-4200 USA

☎ (321) 637-1000 • Toll Free Engineering Hot line 800-645-5828

☎ Fax: (321) 637-1600 🌐 Web Site: www.rencousa.com 📧 E-mail: sales@rencousa.com

| <b>RL-1124</b> |            |                 |                                 |
|----------------|------------|-----------------|---------------------------------|
| Renco Part No. | Inductance | Max. DCR (Ohms) | Suggested Rated Current AC Amps |
| RL-1124-.0010  | 1.0μH      | .011            | .707                            |
| RL-1124-.0012  | 1.2μH      | .012            | .707                            |
| RL-1124-.0015  | 1.5μH      | .012            | .707                            |
| RL-1124-.0018  | 1.8μH      | .012            | .707                            |
| RL-1124-.0022  | 2.2μH      | .012            | .707                            |
| RL-1124-.0027  | 2.7μH      | .013            | .707                            |
| RL-1124-.0033  | 3.3μH      | .013            | .707                            |
| RL-1124-.0039  | 3.9μH      | .014            | .707                            |
| RL-1124-.0047  | 4.7μH      | .014            | .707                            |
| RL-1124-.0056  | 5.6μH      | .017            | .707                            |
| RL-1124-.0068  | 6.8μH      | .018            | .707                            |
| RL-1124-.0082  | 8.2μH      | .018            | .707                            |
| RL-1124-.0100  | 10.0μH     | .020            | .707                            |
| RL-1124-.0120  | 12.0μH     | .022            | .707                            |
| RL-1124-.0150  | 15.0μH     | .024            | .707                            |
| RL-1124-.0180  | 18.0μH     | .030            | .707                            |
| RL-1124-.0220  | 22.0μH     | .032            | .707                            |
| RL-1124-.0270  | 27.0μH     | .034            | .707                            |
| RL-1124-.0330  | 33.0μH     | .036            | .707                            |
| RL-1124-.0390  | 39.0μH     | .038            | .707                            |
| RL-1124-.0470  | 47.0μH     | .040            | .707                            |
| RL-1124-.0560  | 56.0μH     | .046            | .707                            |
| RL-1124-.0680  | 68.0μH     | .047            | .707                            |
| RL-1124-.0820  | 82.0μH     | .050            | .707                            |
| RL-1124-.1000  | 100.0μH    | .054            | .707                            |
| RL-1124-.1200  | 120.0μH    | .059            | .707                            |
| RL-1124-.1500  | 150.0μH    | .073            | .707                            |
| RL-1124-.1800  | 180.0μH    | .078            | .707                            |
| RL-1124-.2200  | 220.0μH    | .082            | .707                            |
| RL-1124-.2700  | 270.0μH    | .098            | .707                            |
| RL-1124-.3300  | 330.0μH    | .132            | .556                            |
| RL-1124-.3900  | 390.0μH    | .142            | .556                            |
| RL-1124-.4700  | 470.0μH    | .170            | .556                            |
| RL-1124-.5600  | 560.0μH    | .222            | .437                            |
| RL-1124-.6800  | 680.0μH    | .235            | .437                            |
| RL-1124-.8200  | 820.0μH    | .247            | .437                            |
| RL-1124-1.0    | 1.0mH      | .440            | .350                            |
| RL-1124-1.2    | 1.2mH      | .470            | .350                            |
| RL-1124-1.5    | 1.5mH      | .640            | .277                            |
| RL-1124-1.8    | 1.8mH      | .700            | .277                            |
| RL-1124-2.2    | 2.2mH      | .925            | .224                            |
| RL-1124-2.7    | 2.7mH      | 1.02            | .224                            |
| RL-1124-3.3    | 3.3mH      | 1.16            | .224                            |
| RL-1124-3.9    | 3.9mH      | 1.61            | .175                            |
| RL-1124-4.7    | 4.7mH      | 1.69            | .175                            |
| RL-1124-5.6    | 5.6mH      | 2.42            | .139                            |
| RL-1124-6.8    | 6.8mH      | 2.57            | .139                            |
| RL-1124-8.2    | 8.2mH      | 3.19            | .110                            |
| RL-1124-10     | 10.0mH     | 4.16            | .110                            |
| RL-1124-12     | 12.0mH     | 4.32            | .110                            |
| RL-1124-15     | 15.0mH     | 4.96            | .110                            |
| RL-1124-18     | 18.0mH     | 5.28            | .110                            |
| RL-1124-22     | 22.0mH     | 9.06            | .080                            |
| RL-1124-27     | 27.0mH     | 9.12            | .080                            |
| RL-1124-33     | 33.0mH     | 12.18           | .071                            |

| <b>RL-1124</b> |            |                 |                                 |
|----------------|------------|-----------------|---------------------------------|
| Renco Part No. | Inductance | Max. DCR (Ohms) | Suggested Rated Current AC Amps |
| RL-1124-39     | 39.0mH     | 14.16           | .071                            |
| RL-1124-47     | 47.0mH     | 17.18           | .056                            |
| RL-1124-56     | 56.0mH     | 18.71           | .056                            |
| RL-1124-68     | 68.0mH     | 27.36           | .043                            |
| RL-1124-82     | 82.0mH     | 31.32           | .043                            |
| RL-1124-100    | 100.0mH    | 42.84           | .034                            |
| RL-1124-120    | 120.0mH    | 47.16           | .034                            |
| RL-1124-150    | 150.0mH    | 61.56           | .027                            |
| RL-1124-180    | 180.0mH    | 69.12           | .027                            |
| RL-1124-220    | 220.0mH    | 90.0            | .027                            |
| RL-1124-270    | 270.0mH    | 100.0           | .027                            |
| RL-1124-330    | 330.0mH    | 117.0           | .022                            |
| RL-1124-390    | 390.0mH    | 125.0           | .022                            |
| RL-1124-470    | 470.0mH    | 183.0           | .017                            |
| RL-1124-560    | 560.0mH    | 206.0           | .017                            |
| RL-1124-680    | 680.0mH    | 282.0           | .014                            |
| RL-1124-820    | 820.0mH    | 356.0           | .011                            |
| RL-1124-1000   | 1.0H       | 410.0           | .011                            |
| RL-1124-1200   | 1.2H       | 568.0           | .0086                           |
| RL-1124-1500   | 1.5H       | 634.0           | .0086                           |
| RL-1124-1800   | 1.8H       | 950.0           | .0069                           |
| RL-1124-2200   | 2.2H       | 964.0           | .0069                           |
| RL-1124-2700   | 2.7H       | 987.0           | .0054                           |
| RL-1124-3300   | 3.3H       | 1400.0          | .0054                           |
| RL-1124-3900   | 3.9H       | 1682.0          | .0054                           |
| RL-1124-4700   | 4.7H       | 1700.0          | .0054                           |

Inductance values shown in μH = microHenrys, mH = milliHenrys and H = Henrys

**NOTES:**

1. Ends epoxy sealed
2. -55°C to +130°C
3. 20% tolerance standard
4. 10% tolerance optional
5. Available taped and reeled.
6. Inductance measured at 1KHz



**RENCO ELECTRONICS, INC.**

595 International Place, Rockledge, FL 32955-4200 USA

(321) 637-1000 • Toll Free Engineering Hot line 800-645-5828

Fax: (321) 637-1600 Web Site: www.rencousa.com E-mail: sales@rencousa.com